

HARDWARE: ADJUSTABLE OFFSET PLUMBIZERS

Overview

The Adjustable Offset Plumbizer mounts onto a 2 3/8" diameter mast arm tenon. It is adjustable for precise orientation (2 piece assembly—18° of adjustment).

The Plumbizer has no loose parts, therefore requiring no assembly. The device is installed between signal heads to minimize stress, while allowing easy access to adjustment bolts for secure installation

The octagonal universal nut (with set screw option for locking) reduces over torque of nut on the heads (T Type).The Plumbizer has radial serrations to ensure proper and secure locking between heads and plumbizer mounts.

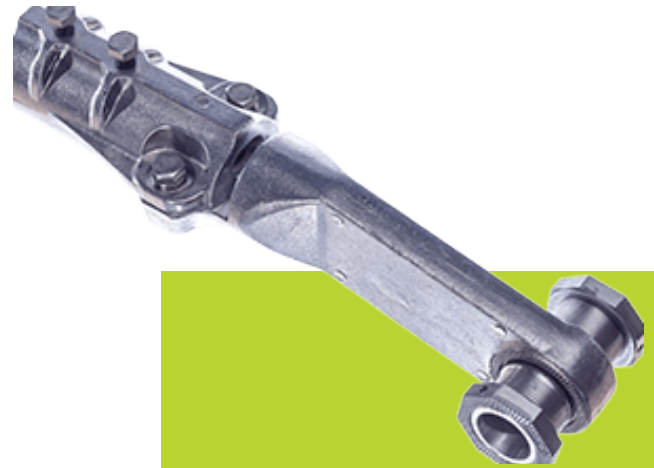

Features

- Adjustable for precise orientation
- Minimizes stress
- Simplified installation
- Stainless steel hardware
- Weight: 3.6 lbs (1.65 kg)
- Single point mount
- Added visibility

HARDWARE: ADJUSTABLE OFFSET PLUMBIZER

Specifications

- Material: Primary grade aluminum alloy
- Finish: Cast aluminum, unpainted can be painted as per request

Ordering Information

Part #	Description
PLU555	T-type Nipple
PLU553	TRI-BOLT Joining Kit

Fortran has many other configurations to meet your specific requirements. For other configurations, options, and accessories, please contact the Sales Department at Fortran Traffic Systems Limited.

Related Products



Post-Top Bracket

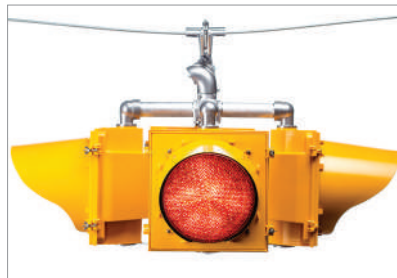

Beacon Signal



CAN-BRAC Universal Signal